

WiFi 7 Black Rod Antenna

FEATURES



- Enhanced hinge structure for vibration environs
- Designed for both Indoor & Outdoor applications
- Dipole Antenna, Ground Plane Independent
- Wide band Antenna
- Full 2400-2500, 5100-7200 MHz backward compatibility
- 4.6 dBi Peak Gain
- Vertically (90°), suitable for compact space multi-antenna installation



The MyAntenna M02-0200100R0A range of antennas are designed to decrease the lifetime cost of M2M and mobile device installations by offering a robust, effective antenna that is easy to install and lasts the lifetime of the installation without the need for maintenance.

The antenna offers ground-plane independent Omni-directional performance Wi-Fi & Bluetooth making it a versatile solution for any number of applications. The efficient element design ensures a high first time connection rate and an ongoing, robust communications link even in problematic coverage areas.

PRODUCTS

| Model | Part No. | Weight | Dimensions (L x W x H) | Connector | Color |
|---------|----------------|--------|------------------------|-----------|-------|
| AEWW032 | M02-0200280R0A | 16g | Φ13*195mm | SMA Male | Black |

SPECIFICATIONS

| PARAMETER | SPECIFICATION | |
|------------------------------------|-------------------------|-----------|
| Frequency Bands, MHz | 2400-2500 | 5100-7200 |
| VSWR (Max) | 1.61:1 | 2.09:1 |
| Peak Gain, dBi (Typ) | Up to 2.56 | |
| Max Efficiency (%) | 82.84 | |
| Nominal Impedance | 50 Ω | |
| Max Power (ambient temp of 25°C) | 10 Watts | |
| Azimuth Beam Width (deg) | Omnidirectional | |
| Polarization | Linear, Omnidirectional | |
| Radome | PC, Black | |
| Storage Temperature Range (°C) | -40° C to +85° C | |
| Operational Temperature Range (°C) | -30° C to +80° C | |
| Material Substance Compliance | REACH/RoHS Compliant | |
| HSCODE | 8517707090 | |
| USHSCODE | 8517620010 | |
| UPC | | |

MyAntenna RF Technology Co., Ltd

ADD: Room 410, Building A, Fenghuang Zhigu, No. 50 Tiezi Road, Gongle Community, Xixiang Street, Baoan District, Shenzhen

TEL: +86-0755-86503881 FAX: +86-0755-27801677 E-mail: nfc@myantenna.com

ELECTRICAL DATA

Return Loss

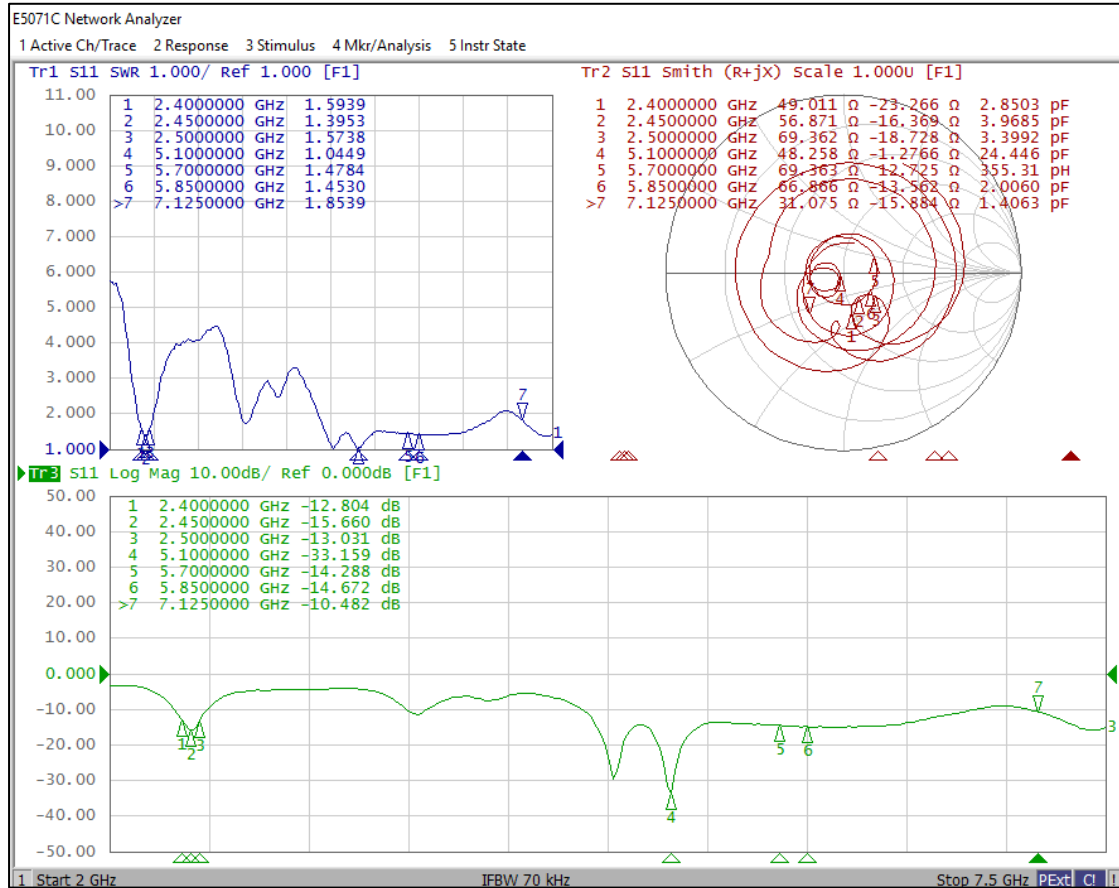

Gain(dBi) and Efficiency (%)

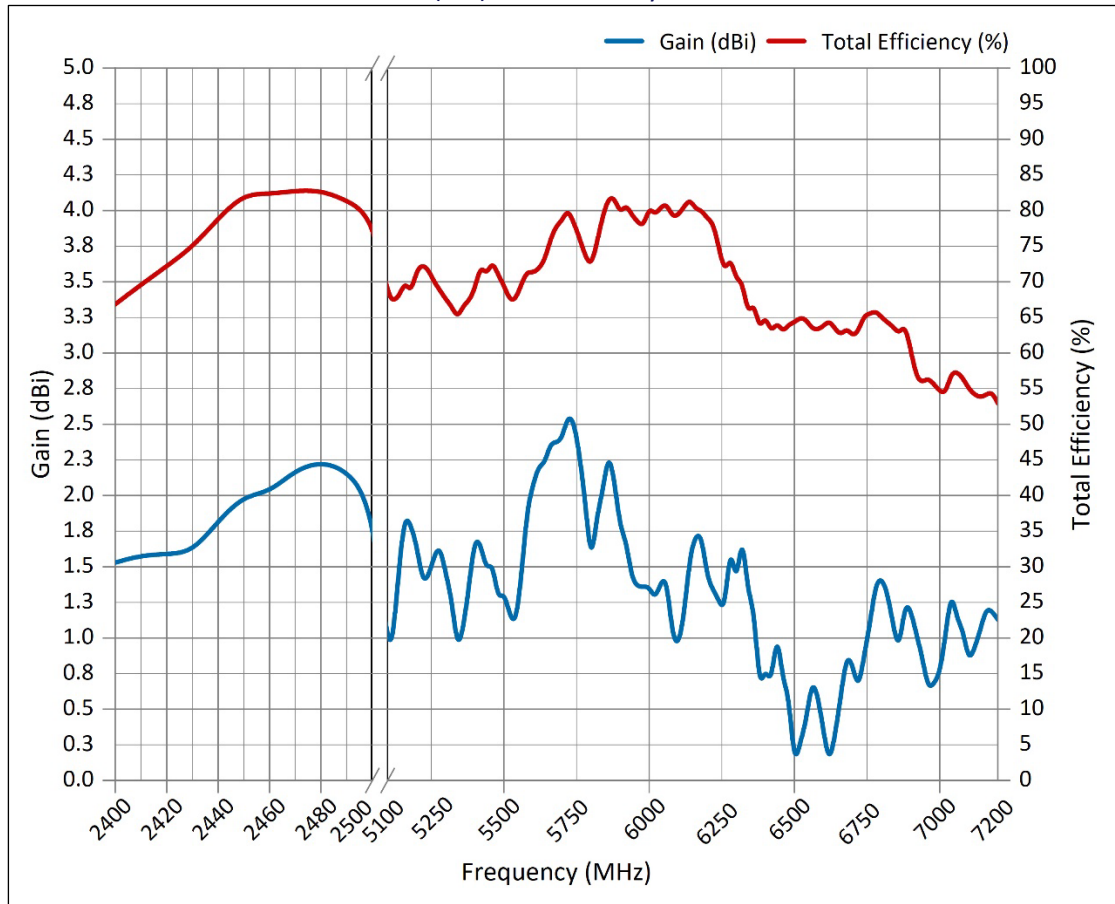

| Frequency (MHz) | Gain (dBi) | Efficiency (%) | Frequency (MHz) | Gain (dBi) | Efficiency (%) | Frequency (MHz) | Gain (dBi) | Efficiency (%) |
|-----------------|------------|----------------|-----------------|------------|----------------|-----------------|------------|----------------|
| 2400 | 1.53 | 66.85 | 5660 | 2.37 | 75.96 | 6440 | 1.07 | 64.38 |
| 2410 | 1.58 | 69.58 | 5680 | 2.37 | 77.87 | 6460 | 0.69 | 62.89 |
| 2420 | 1.59 | 72.2 | 5700 | 2.4 | 78.6 | 6480 | 0.62 | 64 |
| 2430 | 1.6 | 74.84 | 5720 | 2.56 | 80.24 | 6500 | 0.09 | 64.3 |
| 2440 | 1.82 | 78.86 | 5740 | 2.53 | 78.33 | 6520 | 0.27 | 64.99 |
| 2450 | 2 | 82.39 | 5760 | 2.29 | 76.21 | 6540 | 0.41 | 64.71 |
| 2460 | 2.02 | 82.3 | 5780 | 1.96 | 73.56 | 6560 | 0.71 | 63.44 |
| 2470 | 2.18 | 82.79 | 5800 | 1.5 | 72.19 | 6580 | 0.6 | 63.29 |
| 2480 | 2.24 | 82.84 | 5820 | 1.86 | 75.38 | 6600 | 0.35 | 63.79 |
| 2490 | 2.18 | 81.47 | 5840 | 2.02 | 79.21 | 6620 | 0.11 | 64.6 |
| 2500 | 1.95 | 79.29 | 5860 | 2.31 | 81.77 | 6640 | 0.32 | 63.38 |
| 5100 | 0.89 | 68.05 | 5880 | 2.11 | 81.85 | 6660 | 0.6 | 62.49 |
| 5120 | 1.02 | 67.29 | 5900 | 1.77 | 79.57 | 6680 | 0.89 | 63.55 |
| 5140 | 1.53 | 68.04 | 5920 | 1.69 | 80.91 | 6700 | 0.81 | 62.35 |
| 5160 | 1.87 | 70.04 | 5940 | 1.42 | 79.41 | 6720 | 0.63 | 63.06 |
| 5180 | 1.79 | 68.4 | 5960 | 1.36 | 78.44 | 6740 | 0.88 | 65.3 |
| 5200 | 1.65 | 71.66 | 5980 | 1.36 | 77.68 | 6760 | 1.1 | 65.52 |
| 5220 | 1.39 | 72.42 | 6000 | 1.36 | 80.54 | 6780 | 1.39 | 65.93 |
| 5240 | 1.43 | 71.68 | 6020 | 1.27 | 79.35 | 6800 | 1.42 | 64.99 |
| 5260 | 1.58 | 69.94 | 6040 | 1.39 | 80.46 | 6820 | 1.32 | 64.33 |
| 5280 | 1.65 | 68.82 | 6060 | 1.43 | 81.01 | 6840 | 1.09 | 63.69 |
| 5300 | 1.45 | 67.53 | 6080 | 1.01 | 79.1 | 6860 | 0.9 | 62.67 |
| 5320 | 1.28 | 66.57 | 6100 | 0.94 | 79.36 | 6880 | 1.25 | 64.05 |
| 5340 | 0.91 | 64.86 | 6120 | 1.16 | 80.57 | 6900 | 1.2 | 60.48 |
| 5360 | 1.07 | 66.68 | 6140 | 1.58 | 81.61 | 6920 | 1.02 | 56.54 |
| 5380 | 1.36 | 67.31 | 6160 | 1.72 | 80.2 | 6940 | 0.87 | 55.86 |
| 5400 | 1.71 | 69 | 6180 | 1.73 | 80.06 | 6960 | 0.64 | 56.5 |
| 5420 | 1.66 | 72.39 | 6200 | 1.42 | 78.89 | 6980 | 0.68 | 55.64 |
| 5440 | 1.47 | 70.89 | 6220 | 1.34 | 78.31 | 7000 | 0.75 | 54.65 |
| 5460 | 1.54 | 72.96 | 6240 | 1.26 | 74.69 | 7020 | 1.02 | 54.32 |
| 5480 | 1.26 | 70.95 | 6260 | 1.18 | 71.34 | 7040 | 1.34 | 57.24 |
| 5500 | 1.33 | 69.55 | 6280 | 1.69 | 73.54 | 7060 | 1.13 | 57.37 |
| 5520 | 1.16 | 67.4 | 6300 | 1.34 | 70.18 | 7080 | 1.06 | 56.5 |
| 5540 | 1.09 | 67.45 | 6320 | 1.77 | 70.24 | 7100 | 0.83 | 55 |
| 5560 | 1.43 | 69.68 | 6340 | 1.3 | 65.31 | 7120 | 0.93 | 54.16 |
| 5580 | 1.91 | 71.48 | 6360 | 1.23 | 67.22 | 7140 | 1.06 | 53.77 |
| 5600 | 2.07 | 71.26 | 6380 | 0.62 | 63.2 | 7160 | 1.21 | 54.15 |
| 5620 | 2.21 | 71.83 | 6400 | 0.8 | 65.33 | 7180 | 1.19 | 54.6 |
| 5640 | 2.22 | 73.01 | 6420 | 0.66 | 62.83 | 7200 | 1.13 | 52.96 |

RADIATION PATTERNS

2D Radiation Pattern at 2450MHz

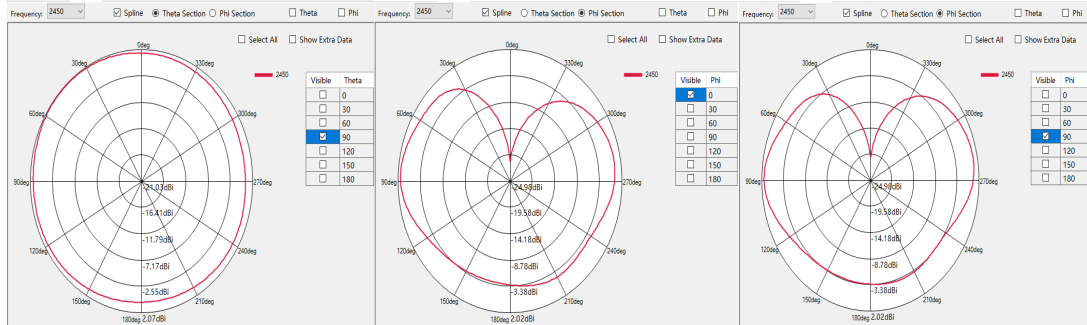

2D Radiation Pattern at 5550MHz

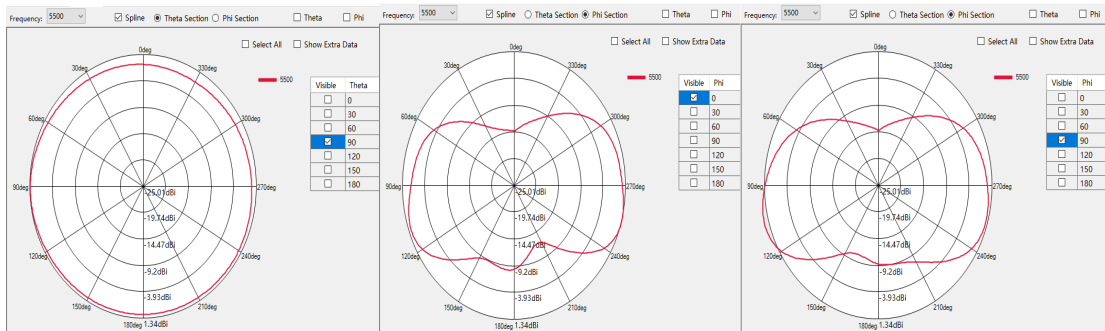

2D Radiation Pattern at 6500MHz

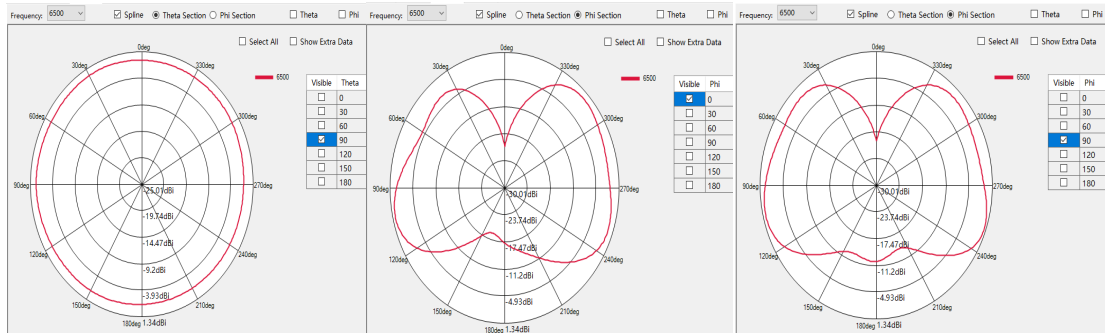

3D Radiation Pattern at 2450MHz

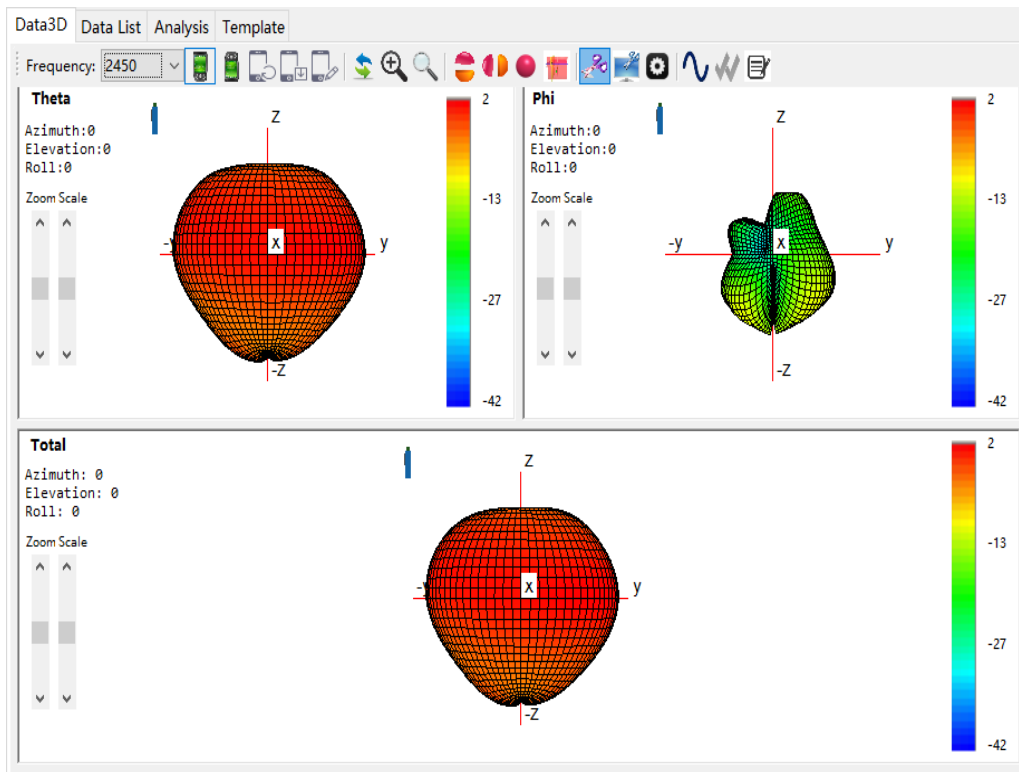

3D Radiation Pattern at 5550MHz

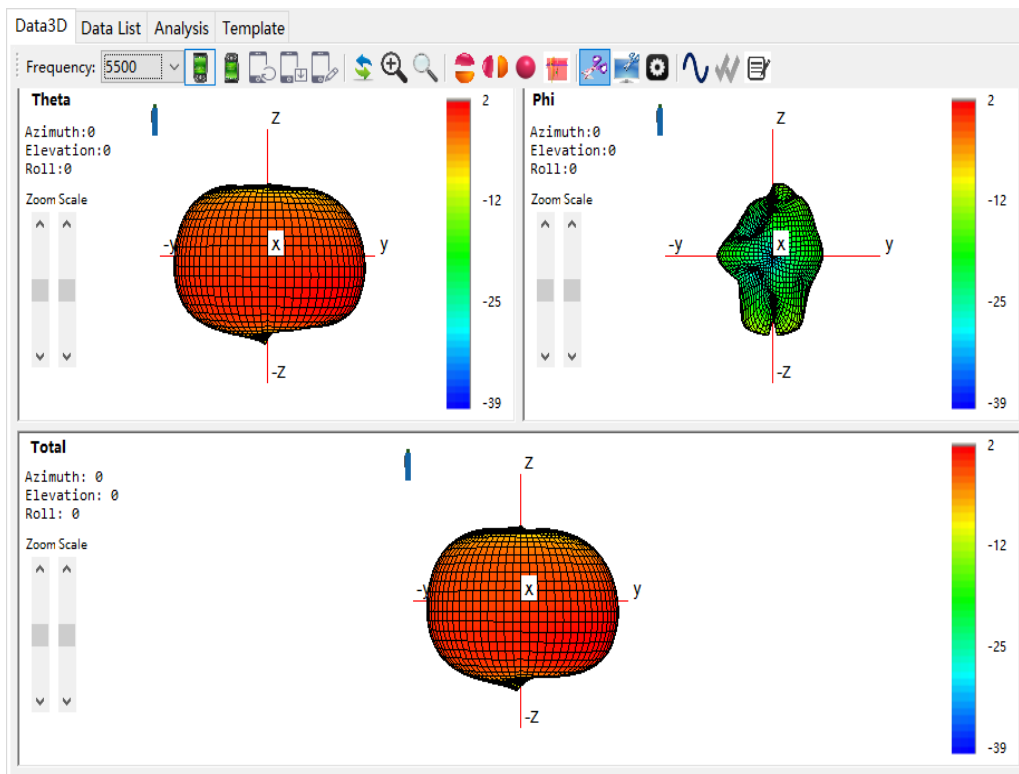

3D Radiation Pattern at 6500MHz

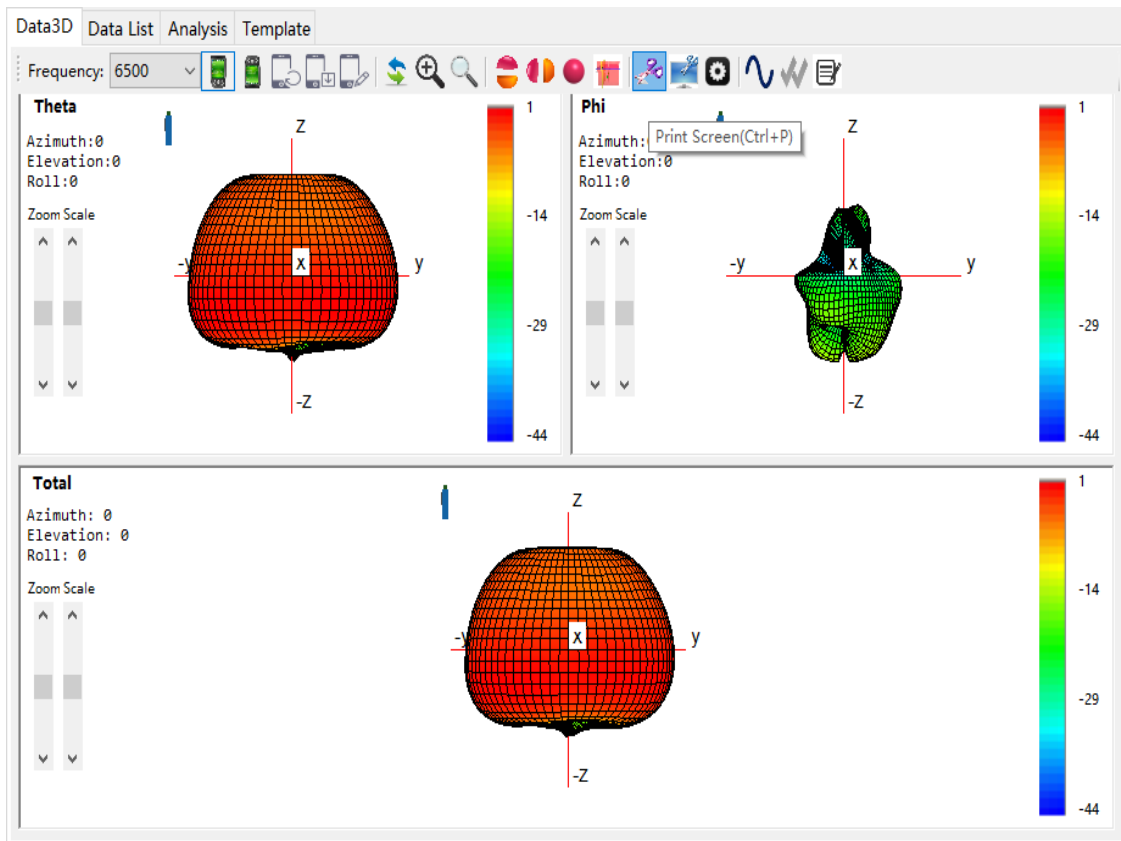

HOUSING CONFIGURATIONS

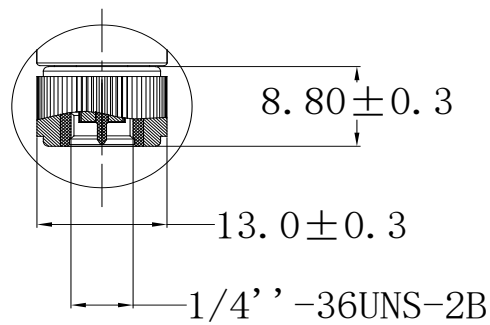
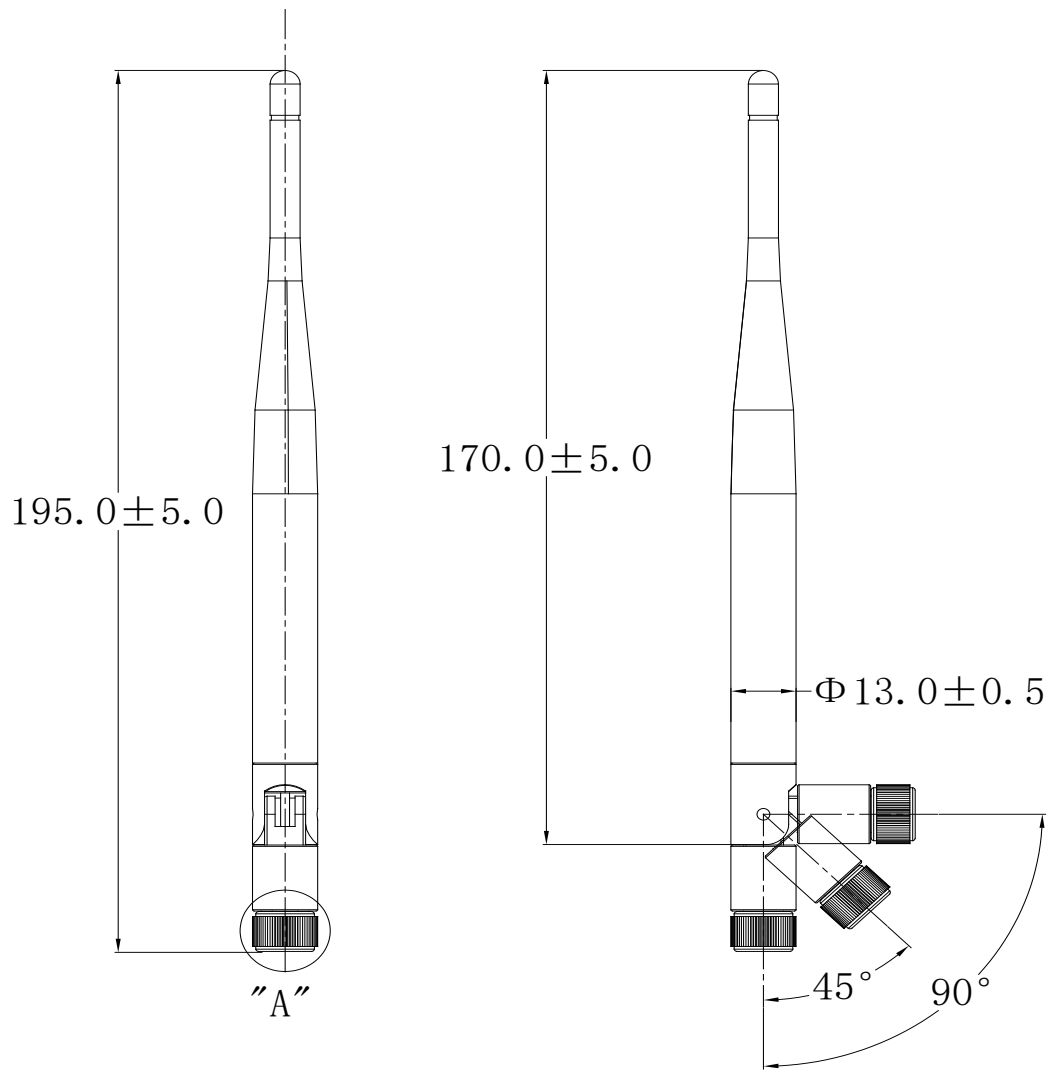

SMA-Male DETAIL A

SCALE 2:1

Abosty™ is owned by Shenzhen MyAntenna RF Technology Co., Ltd. (often abbreviated as MyAntenna).

MyAntenna RF Technology Co., Ltd

ADD: Room 410, Building A, Fenghuang Zhigu, No. 50 Tiezi Road, Gongle Community, Xixiang Street, Baoan District, Shenzhen, China.

TEL: +86-0755-86503881 FAX: +86-0755-27801677 E-mail: nfc@myantenna.com